

## QUICK START GUIDE

This manual can tell you the basic steps of connecting the LED LCD panel.  
If you have any questions, please read the full User Manual on the disc.

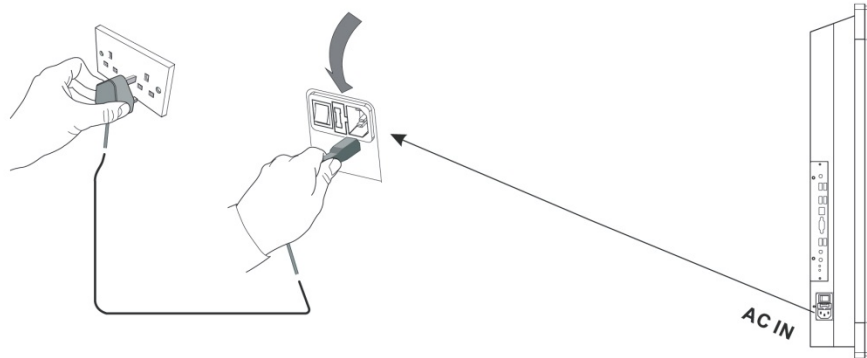

- Plug the mains lead into an appropriate socket
- Switch on the power from behind, and the power indicator light will light up red on the front panel.
- Remove the cover on the rear of the remote control as shown, Insert two AAA equivalent batteries.
- Replace the cover by aligning it with the base of the remote control and pressing it back into place.

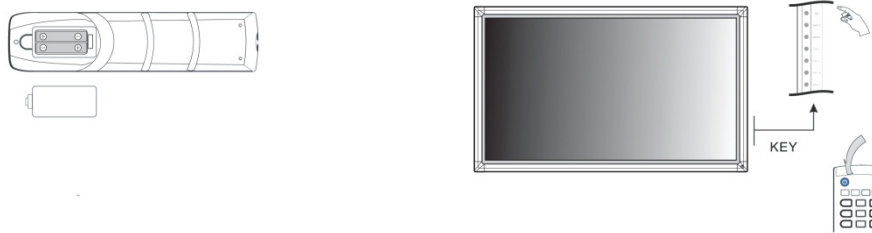

Do not use a rechargeable battery, such as a nickel – cadmium cell. For it has a different shape and function. Please handle the scrap battery in environmental way.

- Press POWER ON/OFF on the side panel or the remote control.
- The unit is operational if the indicator in the lower right corner shows green.
- Press input for the source you need.

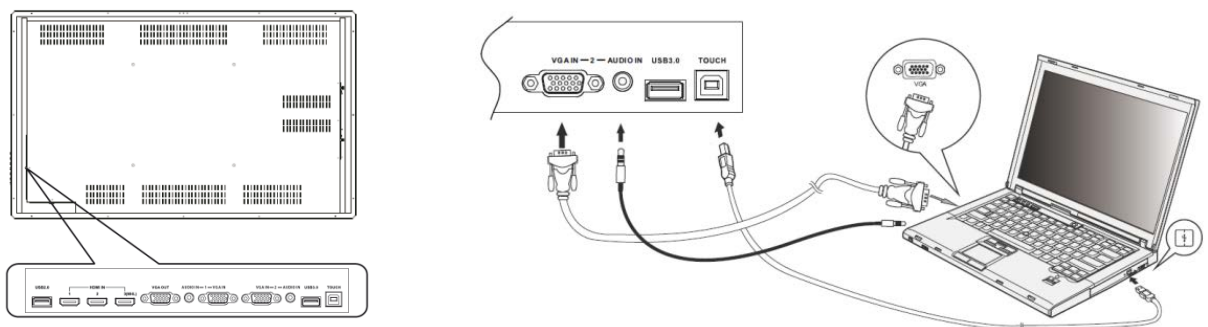

### External PC connection mode

- Connect a VGA cable (15-pin) between the VGA and external PC.
- Connect an audio cable between the PC and audio at the same time.
- Connect a USB cable to the USB terminal under the external PC, Press INPUT switch to PC source.
- Switch the PC to the LED LCD panel.