

## Floor Support for LiftBox for IWB's and LED LCD's

---

## Floor Support for LiftBox for IWB's and LED LCD's Installation manual

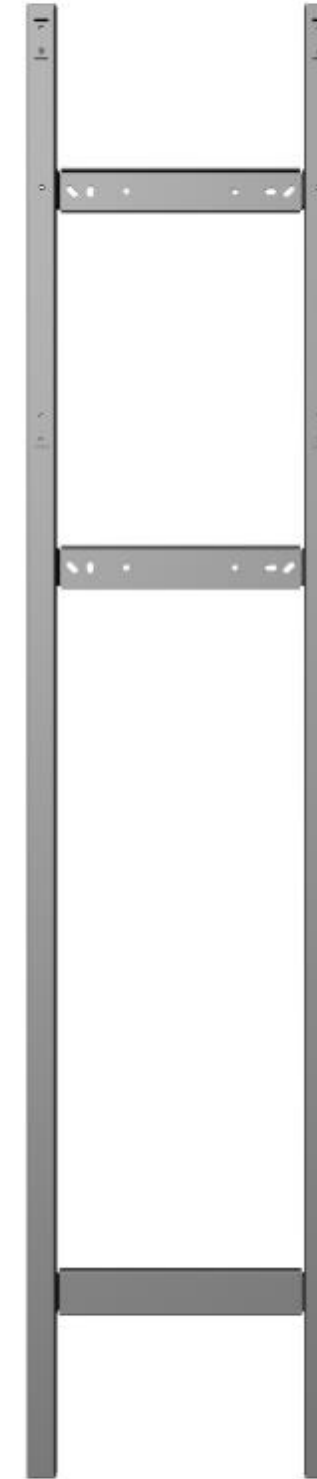

### Floor Support for LiftBox for IWB's and LED LCD's

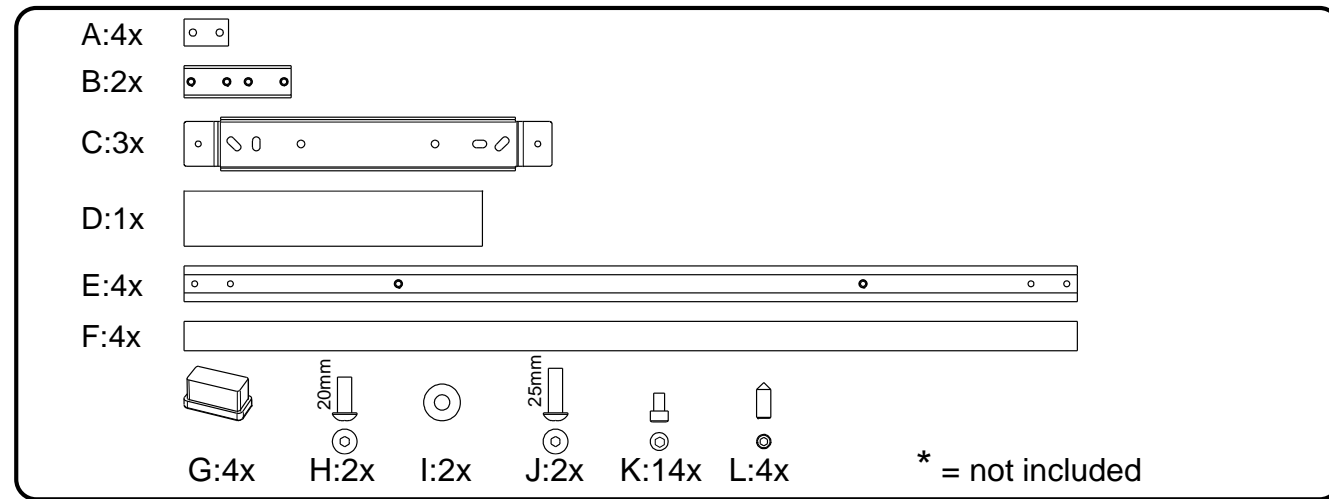

Contents of the box

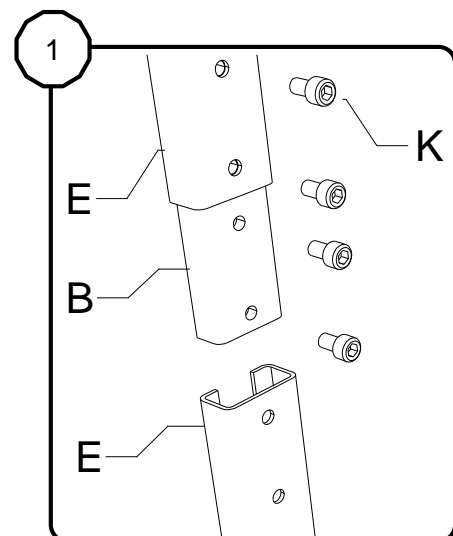

Assemble (● 5 mm)

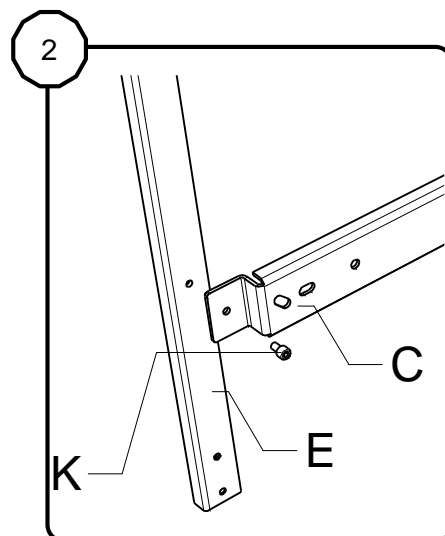

Assemble (● 5 mm)

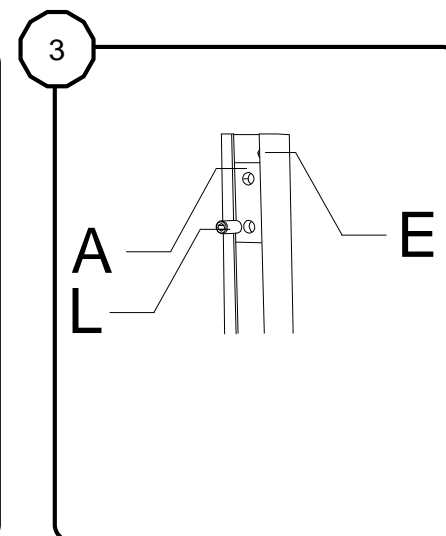

Assemble 4x (● 4 mm)

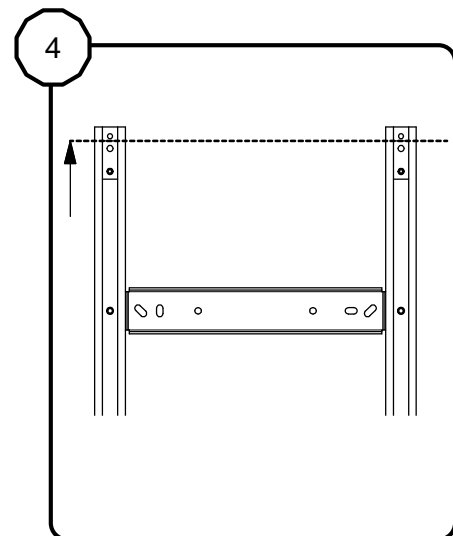

Align top level

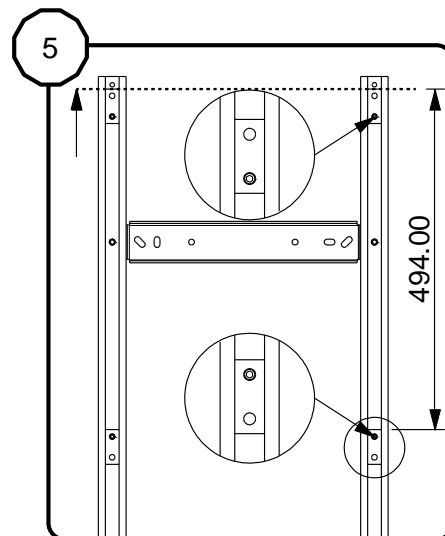

Measure and fix  
(● 4 mm)

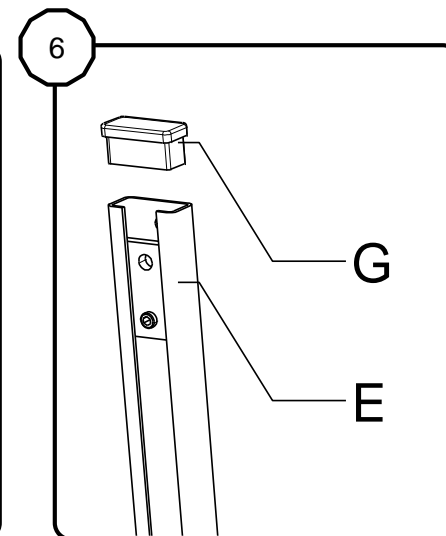

Assemble 4x

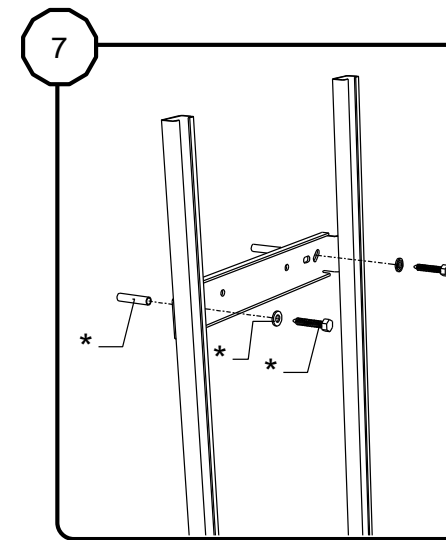

Fix to the wall 3x,  
fasteners not included

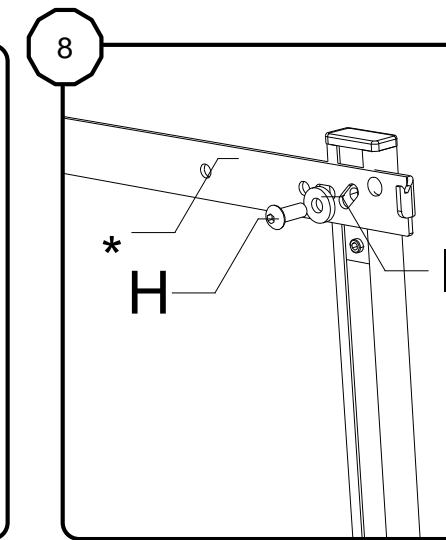

Fix bracket (● 5 mm)  
(\* = not included)

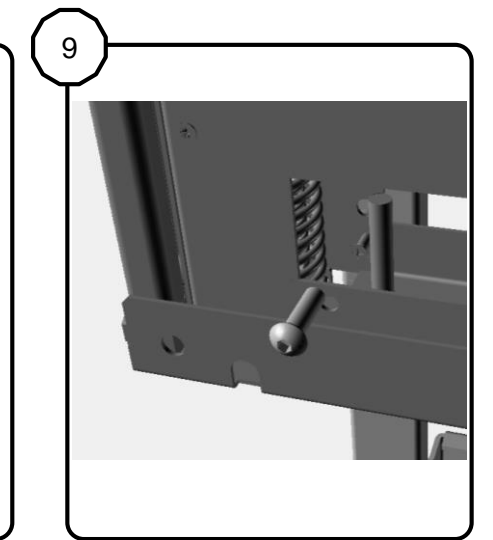

Hang LiftBox (\*) and fix  
at bottom, use screw J  
(● 5 mm)  
**NOTE:** careful not to  
damage grey plastic  
dampener!

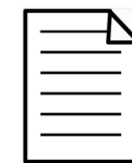

Please refer to  
LiftBox user manual!

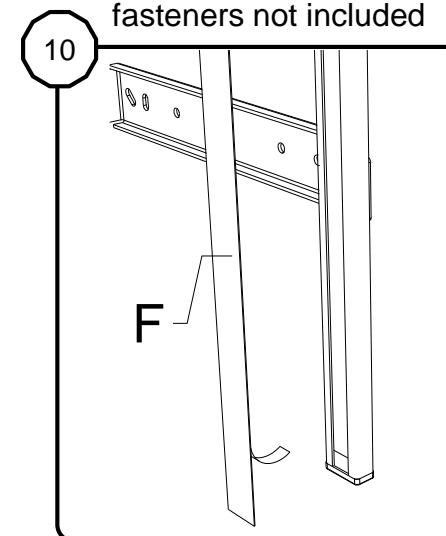

Mount cover strips with  
double sided tape

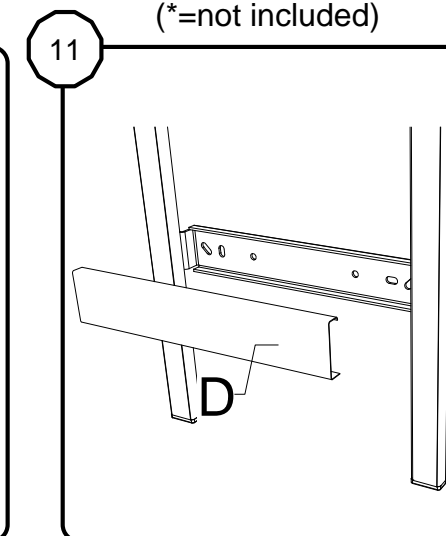

Mount cover